

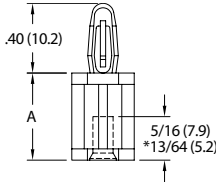

# SCREW MOUNT CIRCUIT BOARD SUPPORTS

## TCBS

### Self-Tapping & Threaded Support



Snap-Lock:  
.156 (4.0)  
Panel Thickness:  
.062 (1.6)

#### Specifications:

- Material: Nylon 6/6
- Color: Natural

#### #6 Self Tapping Screw

Item No.	UL94 V-2	UL94 V-0	A		Bulk Pack Qty.
			In	mm	
TCBS-4-01*	TCBS-4-19*	0.250	6.4	1000	
TCBS-6-01	TCBS-6-19	0.375	9.5	1000	
TCBS-8-01	TCBS-8-19	0.500	12.7	1000	
TCBS-10-01	TCBS-10-19	0.625	15.9	1000	
TCBS-12-01	TCBS-12-19	0.750	19.1	1000	

Item No.	UL94 V-2	UL94 V-0	A		Bulk Pack Qty.
			In	mm	
TCBS-14-01	TCBS-14-19	0.875	22.2	1000	
TCBS-16-01	TCBS-16-19	1.000	25.4	1000	
TCBS-18-01	TCBS-18-19	1.125	28.6	1000	
TCBS-20-01	TCBS-20-19	1.250	31.8	1000	
TCBS-22.5-01	TCBS-22.5-19	1.416	35.7	1000	

## TCBN

### Metric Female Threaded Circuit Board Support

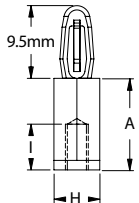

Top Hole:  
Snap-lock: 4mm  
Panel Thickness:  
1.6mm

Bottom Hole:  
See Table for  
Female Thread Size

#### Specifications:

- Material: Nylon 6/6
- Color: Natural
- Flame Class: UL94 HB

#### #M3 or M4 Screw

Item No.	Thread	H mm	A mm	I mm	Bulk Pack Qty.
TCBN-T1-M3-6-5	M3	6	5	3	500
TCBN-T1-M3-6-6	M3	6	6	4	500
TCBN-T1-M3-6-8	M3	6	8	6	500
TCBN-T1-M4-8-5	M4	8	5	3	500
TCBN-T1-M4-8-6	M4	8	6	4	500
TCBN-T1-M4-8-8	M4	8	8	6	500

## LCBS-TF

### Locking Support, Threaded Female

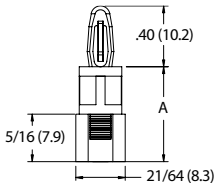

Snap-Lock:  
.156 (4.0)  
Panel Thickness:  
.062 (1.6)

#### Specifications:

- Material: Nylon 6/6
- Color: Natural
- Flame Class: UL94 V-2

#### #6 - 32 Screw

Item No.	UL94 V-2	A		Bulk Pack Qty.
		In	mm	
LCBS-TF-6-01	LCBS-TF-6-19	0.375	9.5	1000
LCBS-TF-8-01	LCBS-TF-8-19	0.500	12.7	1000
LCBS-TF-10-01	LCBS-TF-10-19	0.625	15.9	1000
LCBS-TF-12-01	LCBS-TF-12-19	0.750	19.1	1000
LCBS-TF-14-01	LCBS-TF-14-19	0.875	22.2	1000
LCBS-TF-16-01	LCBS-TF-16-19	1.000	25.4	1000

## LCCBS-TF

### Locking Circuit Board Support, Threaded Female

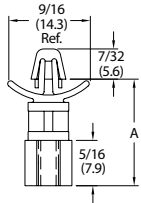

Top Hole:  
Snap-lock: .187 (4.75)  
Panel Thickness:  
.062 (1.57)

Bottom Hole:  
#6-32 Female Thread

- PC board is locked securely in place
- Internal thread to be mounted with a #6-32 screw
- Material: Nylon 6/6
- Color: Natural

#### #6 - 32 Screw

Item No.	UL94 V-2	UL94 V-0	A		Bulk Pack Qty.
			In	mm	
LCCBS-TF-9-01	LCCBS-TF-9-19	0.534	13.6	1000	
LCCBS-TF-10-01	LCCBS-TF-10-19	0.672	17.1	1000	
LCCBS-TF-12-01	LCCBS-TF-12-19	0.797	20.2	1000	
LCCBS-TF-14-01	LCCBS-TF-14-19	0.922	23.4	1000	
LCCBS-TF-16-01	LCCBS-TF-16-19	1.047	25.4	1000	

## CBS-TF

### Circuit Board Support, Threaded Female

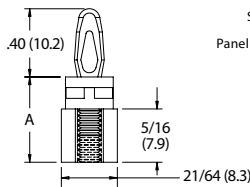
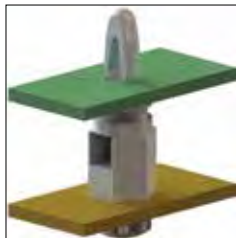

Snap-Lock:  
.156 (4.0)  
Panel Thickness:  
.062 (1.6)

#### Specifications:

- Material: Nylon 6/6
- Color: Natural

#### #6 - 32 Screw

Item No.	UL94 V-2	UL94 V-0	A		Bulk Pack Qty.
			In	mm	
CBS-TF-6-01	CBS-TF-6-19	0.375	9.5	1000	
CBS-TF-8-01	CBS-TF-8-19	0.500	12.7	1000	
CBS-TF-10-01	CBS-TF-10-19	0.625	15.9	1000	
CBS-TF-12-01	CBS-TF-12-19	0.750	19.1	1000	
CBS-TF-14-01	CBS-TF-14-19	0.875	22.2	1000	
CBS-TF-16-01	CBS-TF-16-19	1.000	25.4	1000	